

MICROFILMED

FILED  
GREENVILLE CO. S.C.  
MAY 7 9 47 AM '81  
DONN S. TANKERSLEY  
R.M.C.

DAVIS

STREET

N 57-16 E 721.3

3.221 Ac.

SALUDA LAKE ROAD  
N 71-24 W 287.7

S 12-47 W 145.82

0.215 Ac.

N 87-00 W 43.0

222.0 Total

S 84-36 W 208.9'

S 21-08 E 355.6

WHITE HORSE ROAD (S.C. Hwy. # 250 BY PASS)

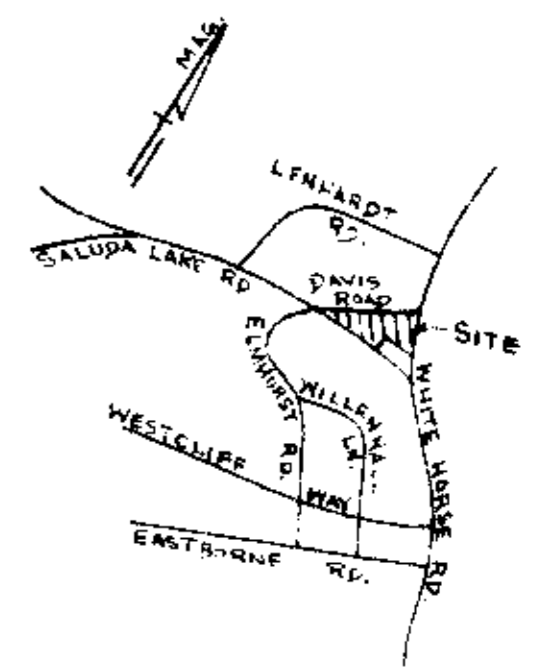

LOCATION

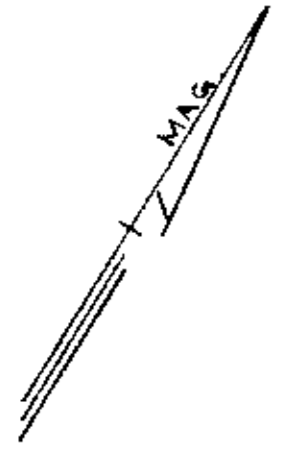

NOTE:  
WATER & SEWER IN STREETS

8 N-27

31173

MAY 7 1981

**THIS PLAT FOR RECORDING**

**THIS PLAT IS NOT A SUBDIVISION AS DEFINED BY THE GREENVILLE COUNTY SUBDIVISION REGULATIONS:**  
4-22-81 *[Signature]*  
Chairman, Secretary, or Director of Planning,  
Greenville County Planning Commission

SURVEY FOR  
I. H. PHILPOT, TR.  
GREENVILLE CO., S. C.  
SCALE 1" = 50' APRIL 16, 1981  
50' 25' 0 50' 100'

I HEREBY CERTIFY THAT THE RATIO OF PRECISION OF THE FIELD SURVEY IS 1/5,000+ AS SHOWN AND THE AREA WAS DETERMINED BY DMD METHOD  
*[Signature]*  
R.L.S. No. 3320

o - IRON PIN

*[Signature]*  
Piedmont Engineers Architects & Planners  
GREENVILLE, S.C.

Plat Divide B3.2-4-6 out of B3.2-4-1